

GALEON



COLLECTION

2019



INNOVATING

with our minds.

DESIGNING

with our hearts.

BUILDING

with our hands.

Welcome *to Galeon*

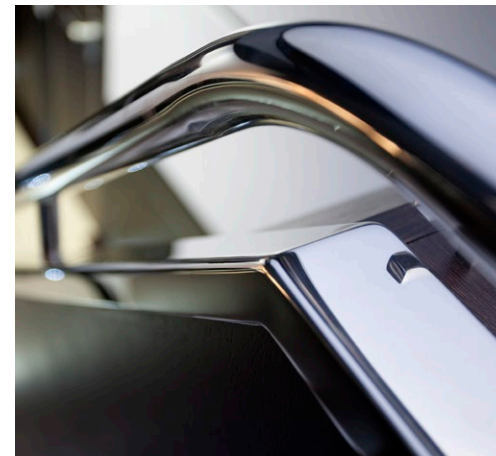

Prepare to be amazed as you explore the lineup of Galeon Yachts for 2019. Each Galeon yacht is a handcrafted masterpiece with many perceptive innovative features no other yacht brands even offer. There are 16-models specially designed for American predilections from 40-feet to 78-feet. Yachts so superbly constructed, they are astounding. Are you ready to Experience Innovation?

Galeon Yachts



Galeon Yachts

- *The Company*

Relatively new to the Americas, Galeon is well established as one of the leading yacht manufacturers in Europe. Founded in 1982 they have over 3-decades of manufacturing experience and a workforce of more the 1,000-skilled engineers, craftsmen and technicians combined with modern production and assembly facilities that makes every Galeon Yacht model exceptional in its class.

Galeon manufactures just about everything. All the cabinetry, the furniture and even the stainless-steel window and door frames are crafted to exacting standards. That means the grains match, the cabinets are solid and stainless-steel fixtures are hefty and perform smoothly.

To assure that all their yachts maintain the highest quality in every detail, Galeon utilizes cutting-edge management, up-to-date production systems and the latest technologies.

The quality and styling of Galeon's class-leading motor yachts reflect the dedication and hard work the Galeon team puts into them. In turn, owning a Galeon Yacht is a symbol of your success and your appreciation of the finer things in life.

MarineMax is the exclusive Galeon dealer in the Americas. With over 60 locations, MarineMax provides a nationwide network that assures your vessel's warranty is backed by industry experts, as well as knowledgeable service and support throughout your total ownership experience.





About *MarineMax*

MarineMax is the world's largest and most trusted yacht dealership. Headquartered in Clearwater, Florida, MarineMax is focused on premium brands, including Galeon Yachts. All MarineMax team members are boating enthusiasts and they are totally dedicated to providing only the best to support their customers boating lifestyle. MarineMax offers new and used recreational boats and related marine products and services as well as providing yacht brokerage and charter services. MarineMax currently has over 60 locations providing the most extensive boating network in the World.

lifestyle is our mission. At MarineMax the sale is simply the beginning of our relationship with our customers. Every MarineMax offers educational seminars such as the exclusive Women on Water Course which helps ladies become confident operating their boat. Nationwide, MarineMax offers the best service and repair, including mobile service at your boats location. Only MarineMax customers can experience pleasure and camaraderie of MarineMax's guided journeys to special destinations.

MarineMax is a New York Stock Exchange-listed company.

Helping you find the boat of your dreams and assisting owners in living their ideal boating

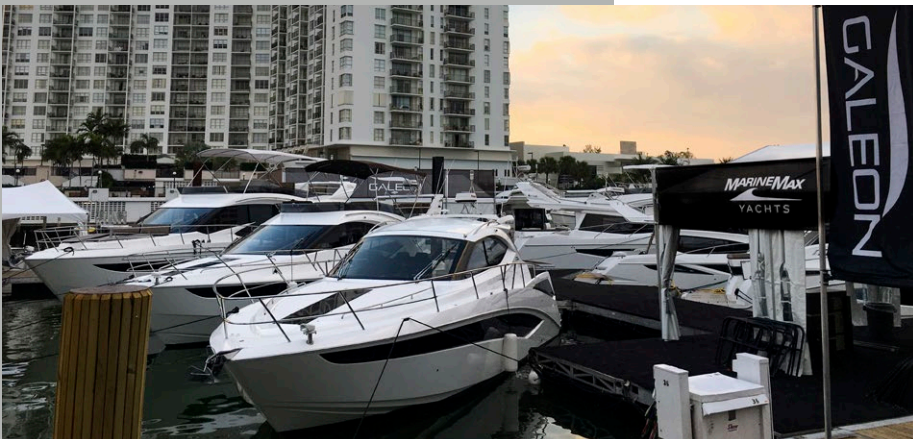

The Galeon *Range*



405 HTS



420 FLY



425 HTS



430 HTC



460 FLY



470 SKYDECK



485 HTS



500 FLY



510 SKYDECK



550 FLY



560 SKYDECK



640 FLY



650 SKYDECK



680 FLY



700 SKYDECK



780 FLY

4.05 HTS

Innovative
Design





740 HP awaits, speed to your destination at 35 knots! —

Famous throughout Europe and around the world, Galeon is known for its intuitive functionality, stunning looks and unmatched performance. The impressive Galeon 405 HTS is no exception.



Make it a family affair with the large convertible cockpit —

The cockpit and helm benefit from large windows and a single pane windshield that provide 360-degree panoramas. The two staterooms replete with two heads that provide you and your guests privacy and comfort below.

The 405 HTS is agile and quick, sure to impress, and confidently bring you endless waterborne adventures.



— Spacious salon and galley



— Skylights and hull windows illuminate this fantastic space



— Large berth with starboard sofa



— Guest twin berths with queen conversion



Single pane glass provides unobstructed views



Outdoor Kitchen with dining table and sunbed conversion



Teak beach with garage for the toys

4.05^{HTS}

Layouts

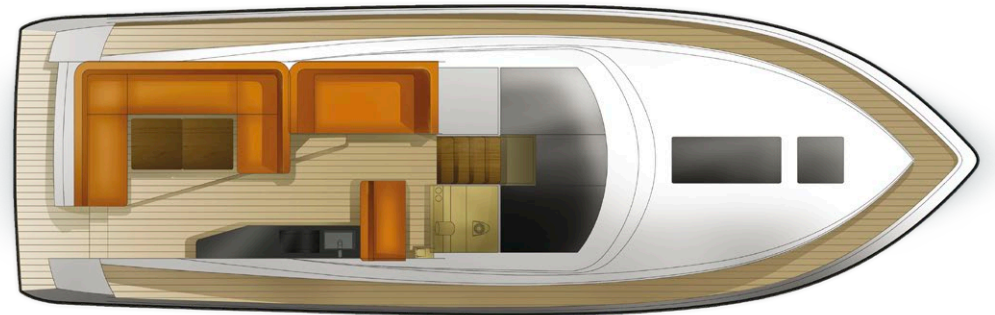

4.20 FLY

Reward
Yourself





Distinct styling and performance

The sophisticated Galeon 420 FLY has a sensational presence with its stunning styling that is as contemporary as it is pleasing. The spacious, wide-open flybridge is perfect for entertaining family and friends.



Explore the adventurer in you

The shaded cockpit adds an additional alfresco social area that connects nicely with the saloon's convertible seating. The master stateroom offers luxurious accommodations with en-suite head when it is time to turn in.

Two guest staterooms provide privacy and comfort for family and guests. Underway, the 420 FLY makes a statement with its exemplary performance which is both powerful and nimble, evoking confidence and pride of ownership.



— Spacious salon with fantastic views



— Power windows allow a cool breeze to pass through

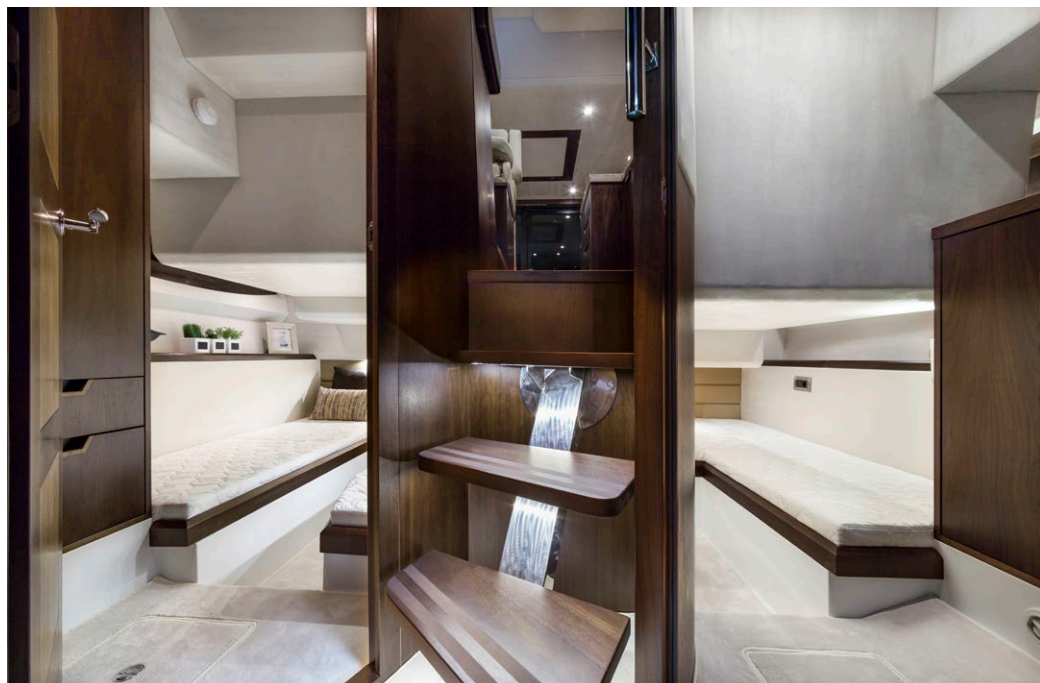

— Available in 2 or 3 cabins, 3 shown here



— Spacious master with ensuite head and skylight



Endless possibilities with this fully appointed helm



Bridge entertaining is a breeze with outdoor kitchen



Expansive cockpit blends outdoor and indoor space

420^{FLY}

Layouts

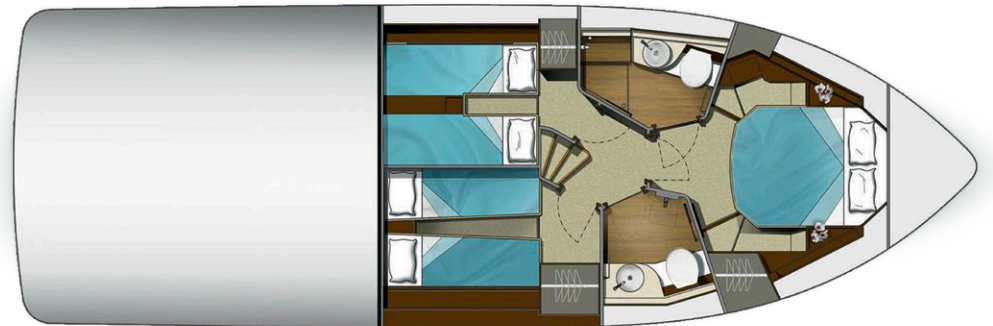
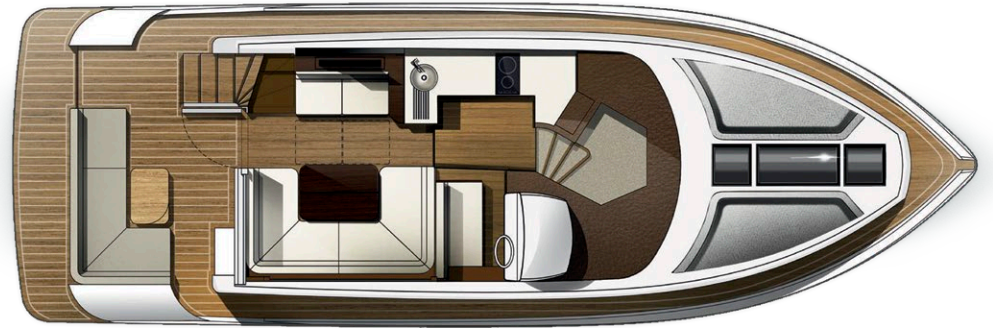
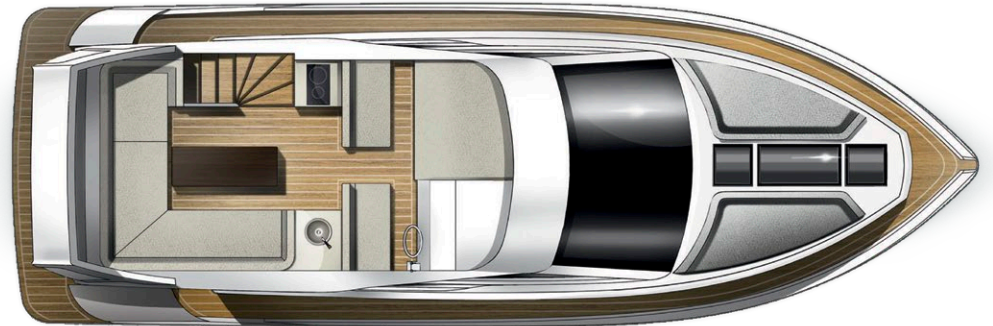

4.25 HTS

Expressive
and Impressive





Thoroughbred performance

The 425 HTS is a smaller sibling to the Galeon 485 HTS. We have re-invigorated the ever popular express style yacht by eliminating the need for soft curtains while still providing a truly open yacht.

Close it up and enjoy the climate controlled cockpit or open the roof, doors, and windows and you can laugh about the old days of fighting canvas to stay dry from the approaching rain shower.



An instant classic with incredible lines

The sleek lines and aggressive profile make it easy to forget the yacht's true nature where functionality and luxury are standard. Features like wide side decks for easy bow access in all weather conditions and garage storage are sure to impress.

Below deck, the salon, two staterooms, and two heads await along with a dinette and galley. The owner's suite is located midship and occupies the whole width of the yacht allowing for an incredible amount of volume and storage space. With an IPS propulsion package, this yacht is revolutionary.



4.25^{HTS}



Layouts

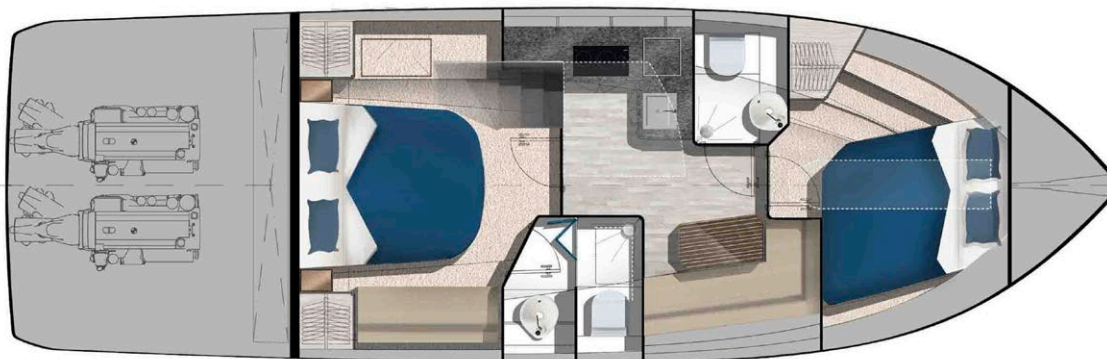
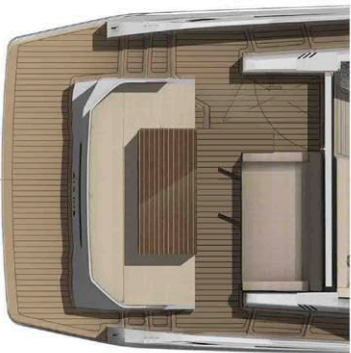

430^{HTC}

Sporty
Character





A coupe without compromise

The Galeon 430 Hard Top Coupe adorns with luxurious accommodations while emoting the senses with the distinguishable, sleek look of a sport-yacht.

She offers a wide opening sunroof over the helm station with automatic port and starboard windows for a very open feel. The sliding aft seat extends the cockpit making the 430 feel like a much larger boat.

The master stateroom is full with luxury and privacy with en-suite master baths. Two private guest staterooms provide comfort for family and guests.



Unique in so many ways, the bow sun pads have built in back rests



— A tremendous feeling of volume and space



— Endless horizons at the full featured helm



— Beautiful master with ensuite head



— Full size refrigerator and open atrium style galley in this two cabin layout



Expandable cockpit with sunbed



Additional sunbed access at the bow



Large swim platform with room for a tender

430^{HTC}

Layouts

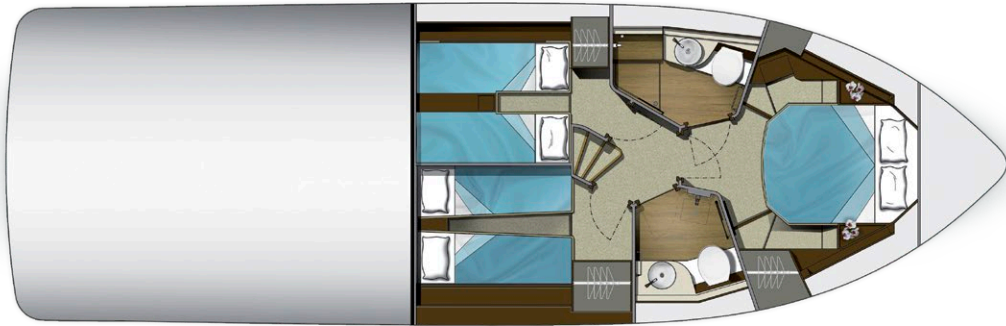
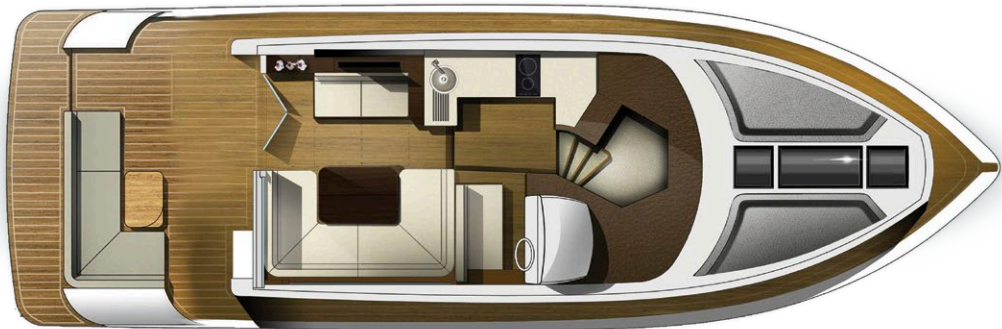
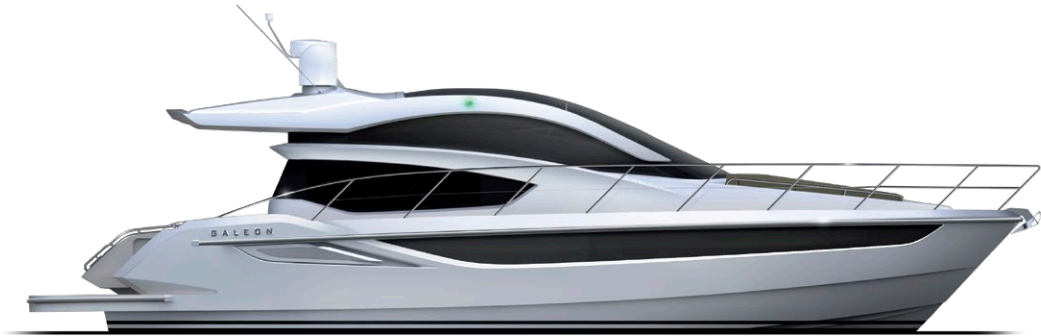

460 FLY

Enjoy Substance
And Style





Expansive windows and and sporty performance with bow seating! —

The 460 FLY shares many design features of its bigger brother, Galeon 500 FLY, with a slightly more compact frame. This daring, new design clearly shows the bold direction Galeon has taken to propel its yachts into the future.



Styling to impress the most discerning critic —

Bow seating on the 460FLY as well as an immense flybridge for a yacht of this size are standout features. But that is not all, Inside the Galeon 460 FLY, is a world of luxury with the exceptional fit and finish all Galeon yachts are known for.

Its full beam midship master stateroom with full headroom around the bed and en-suite head give you the sense of a much larger yacht. Style, luxury, and exquisite accommodation embody the 460FLY.



— Aft galley to serve the cockpit or salon



— Comfortable salon dining area with pop up TV



— Full beam master with walk around queen bed



— Large VIP cabin with skylight



Fully featured ergonomic helm station



Bow seating adds for extra privacy and a wonderful view



Enormous bridge with room for sunning and entertaining

4.60^{FLY}

Layouts

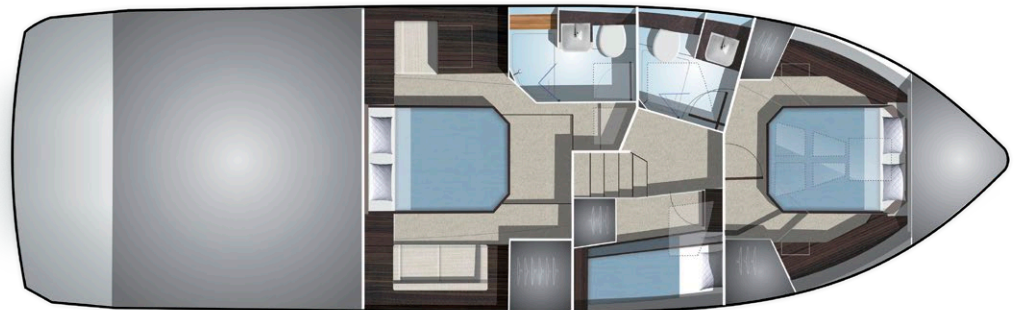
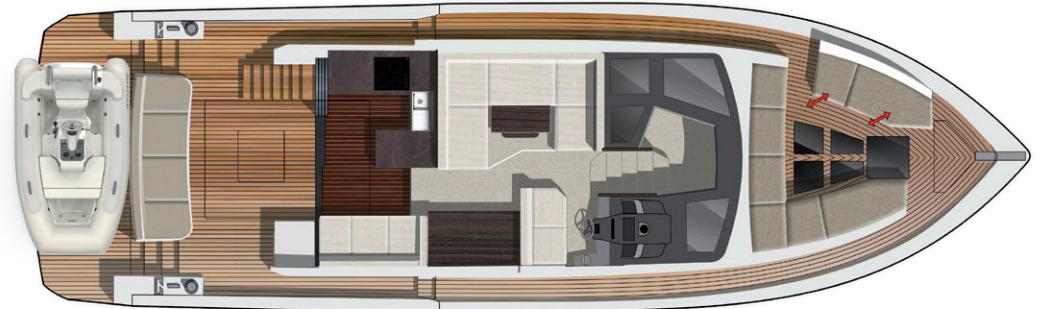
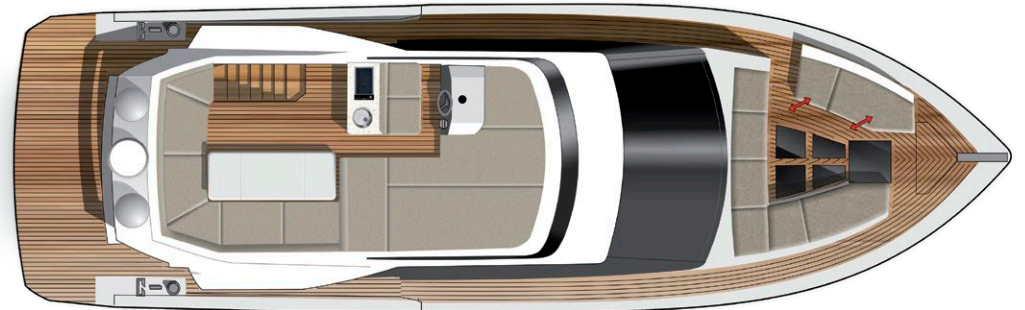

470 SKYDECK

Sleek
and SKYlish





Defying her dimensions, the 470SKY has a hidden sport bridge



The port side balcony makes her a true entertainer

The 470 SKYDECK joins the lineup bringing even more innovation. With her full beam master and 3 cabin layout, the 470 SKY feels like a much larger yacht.

With its sleek lines, no one would suspect that she offers a bridge deck neatly hidden away with a retractable cover revealing a complete helm station and lounge on the sporty bridge.

Expansive seating in the cockpit open to the aft galley makes this a natural entertaining platform for family and friends. An alfresco bar area accessed via the optional port balcony and opening side windows allow for fresh breezes throughout the galley and salon.

With all of these amazing features, it's easy to forget there is a bow seating area to take in endless sunsets and enjoy your new paradise!



— Aft galley and port side bar and slider give an open feeling



— SKY lights create the most open feeling in this amazing layout



— Full beam walk around queen with office/make up center



— Ensuite master head is luxurious



Unique in design, the 470 is the envy of many



Open the bar and let the party begin



The aft dining area is sure to be a popular gathering area for family and friends

470 SKYDECK

Layouts

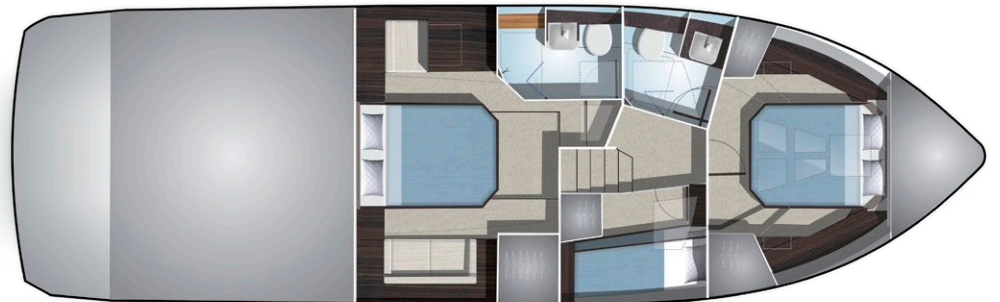
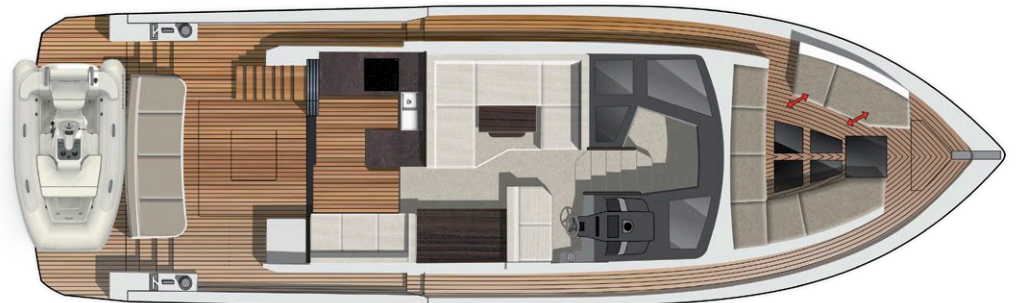
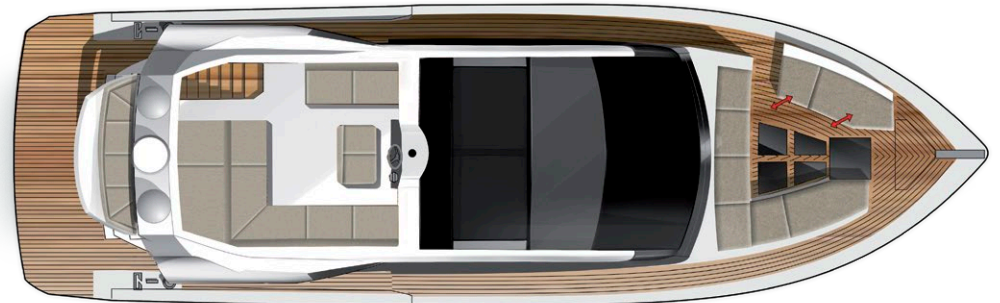



Some Galeon models come equipped with the revolutionary Beach mode option, which allow for both the port and starboard balconies to lower and extend the usable cockpit area. This innovative solution comes at no costs in terms of yacht's practicality, design, reliability or performance yet it changes the way you get to enjoy it completely.

Just imagine what you could do with all that extra space! This is the Galeon yachts ingenuity – the future of luxury yachts.





Galeon Innovations

Beach Mode



4.85 HTS

Fabulous
Performer





Unmistakable styling



30 knot performance

This open-deck model, focuses on providing high maneuverability and a thrilling ride while still maintaining an exceptional level of comfort. The layout of the 485 HTS was conceived to offer a convenient and spacious living arrangement.

The main deck features a U- shaped sofa, wet bar and a helm station with double seats. The cockpit area is occupied by a large sofa/sunbed. The amazing retractable door/window on this model is an engineering marvel and allows the boat to be closed up in seconds without the need for canvas.

Wide sidedecks lead to the bow where an additional social area exists. Every detail reflects Galeon's commitment to quality, craftsmanship, and innovation. There is no other boat in its class that provides the exceptional value that the Galeon 485 HTS represents.



— Expertly crafted and flawless interiors



— Comfort and storage are abundant in the salon and galley



— Full beam master with sofa and ensuite head



— Skylit VIP will leave guests feeling privileged



Single pane glass and retractable sunroof make for amazing visibility



Opening the aft door and window sinuously blend interior and exterior



Aft seating, dining, or sunning highlight the 485s versatility

4.85^{HTS}

Layouts

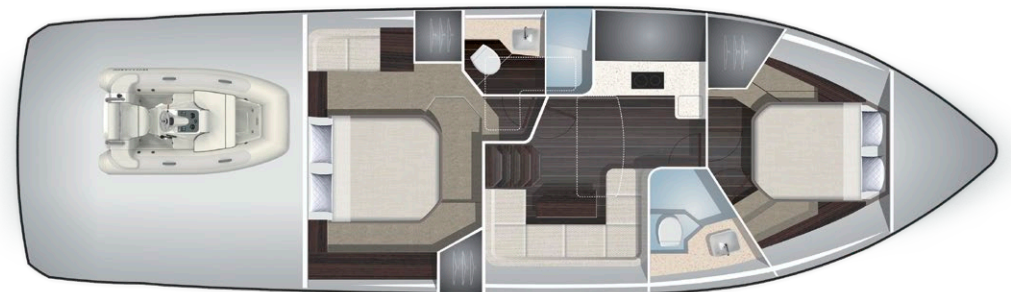
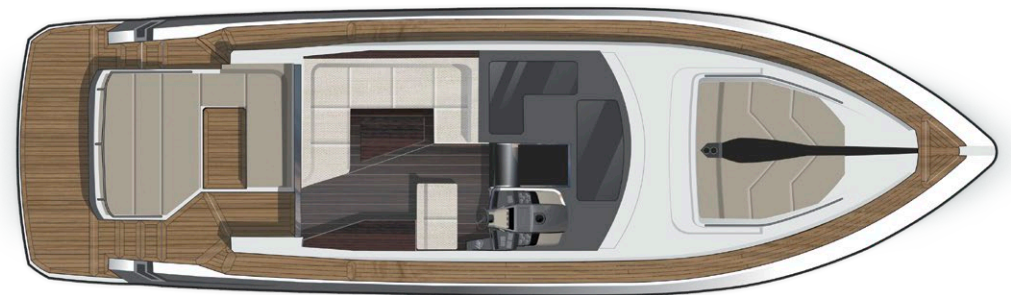

500 FLY

Award Winning
Innovation





Game changing and award winning features



A solid performer with amazing style

The Galeon 500 FLY is the most innovative yacht in its class. With all the luxury and craftsmanship that Galeon is known for, the 500 FLY offers ingeniously unique features that make it an incredible investment in your boating lifestyle.

From the ample flybridge to the large staterooms, the Galeon 500 FLY is engineered to please and excite even the most demanding yacht aficionado while providing an awe-inspiring experience for family and friends. In “beach” mode, the aft, side coaming walls fold down and the saloon windows slide forward to create an amazing openness from amidship to the swim platform.

The large sweeping windows and single pane windshield provide 360-degree views from the saloon, galley and lower helm. The uniquely engineered sliding aft side windows and electric forward side windows allow the saloon to become wide open to the outdoors.

The sumptuous master stateroom is the ideal space for privacy at the end of a day full of socializing and adventure.



— Aft galley to serve cockpit and salon



— Convertible salon for entertaining or lounging



— Large Master with walk around queen and desk/make up center



— Large VIP with unique sky lights and plenty of storage



Rotating seat provides for 360 views



Port side bar is ideal for breakfast or sunset cocktails



Opening the galley side windows is an experience like none other on a yacht this size

500^{FLY}

Layouts

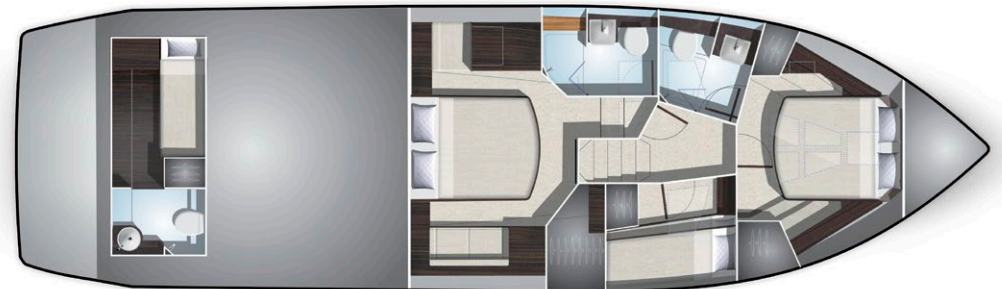
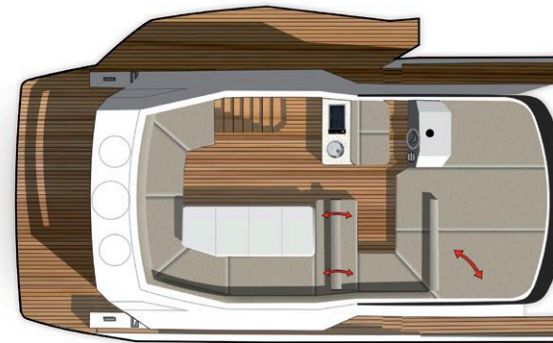
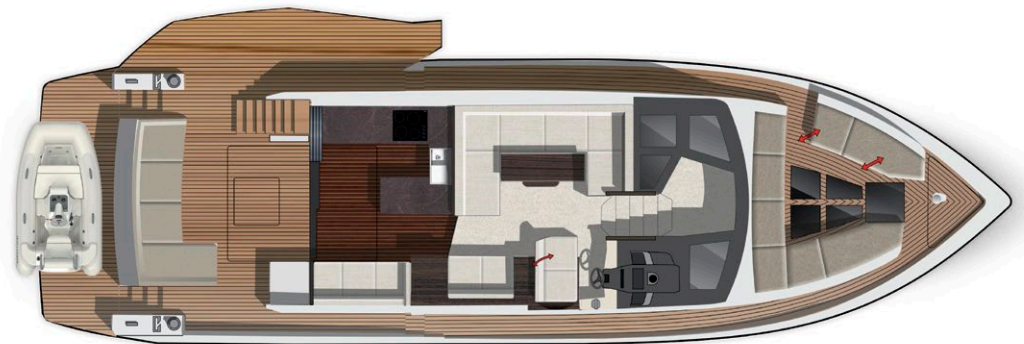

510 SKYDECK

Inspiring Pride
Of Ownership





Truly a family affair, the 510 offers endless possibilities



The balconies on the 510 open it up for a variety of activities

Sharing the same hull design with the 500 FLY, the 510 offers an amazing amount of interior space on all decks – a staple of all Galeon yachts.

With broad windows all around, the passengers will enjoy a bright and welcoming atmosphere on the main deck as well as down below.

What sets the SKYDECK models apart from other yachts is their ability to combine the advantages of having a top deck with the distinct, sporty look of a hardtop. The Galeon 510 also features a full-sized sunroof over the helm and an automatic soft roof to cover the deck when necessary.

Experience the power of innovation and the intense character of the Galeon 510 SKYDECK!



— Like the 500, the aft galley creates flow from cockpit to salon



— The atrium effect in the salon is truly unique



— Walk around queen with desk/make up center



— Luxury awaits in the en suite head



The rotating aft seat with garage option extends the 500's capabilities



At nearly 20' opened up, the entertaining platform is enormous



the SKYdeck is a place to enjoy the powerful engines and performance

510 SKYDECK

Layouts

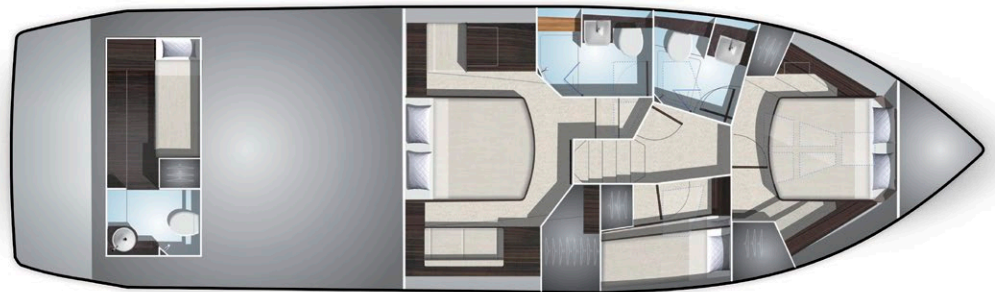
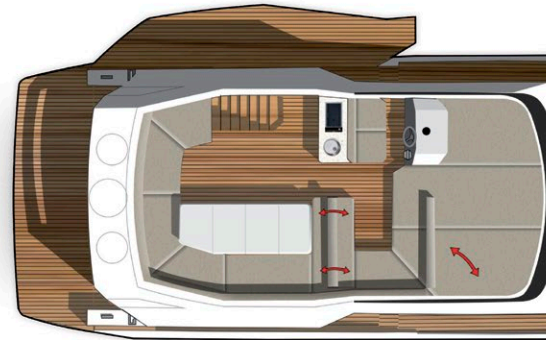
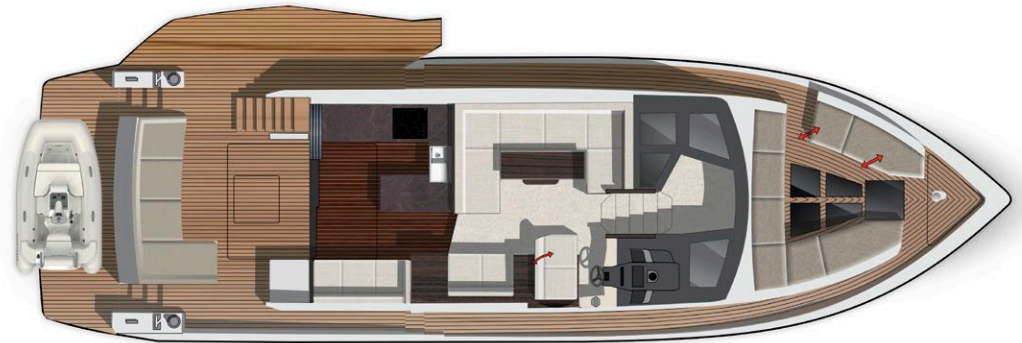

550 FLY

High Performance
Sociability





The optional hard top is superbly designed



A proven performer, the 550 will take you there

Every detail of the Galeon 550 FLY conveys the exacting standards and incredible craftsmanship that combines the skills of old-world artisans with the latest technologies.

With three decks engineered to maximize opulent space for all on-board to luxuriate in comfort, the elegant and refined Galeon 550 FLY is the epitome of form and function coming together in harmony. Experience a yacht that reflects Galeon's commitment to excellence, experience the 550 FLY.

The spacious gourmet galley sits between the cockpit and the saloon by a service bar making it a natural social center. Large windows make the master stateroom light and airy. Accent lighting makes it elegantly contemporary.

The fully equipped upper helm is well positioned to keep the operator engaged with guests while underway.



— The stunning glass walnut interior is sure to impress



— Amazing proportion make the 550 feel like a larger yacht



— The spacious master will become your home away from home



— Beautifully appointed VIP with ample storage



The large cockpit and swim platform are perfect for water adventures



Bow sundeck with drink holders await the sun worshiper in you

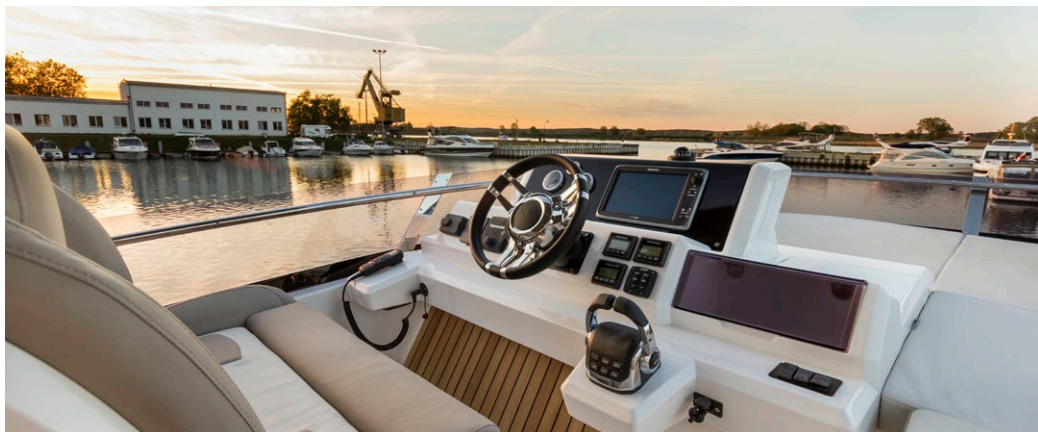

Endless horizons from the full featured bridge helm

550^{FLY}

Layouts

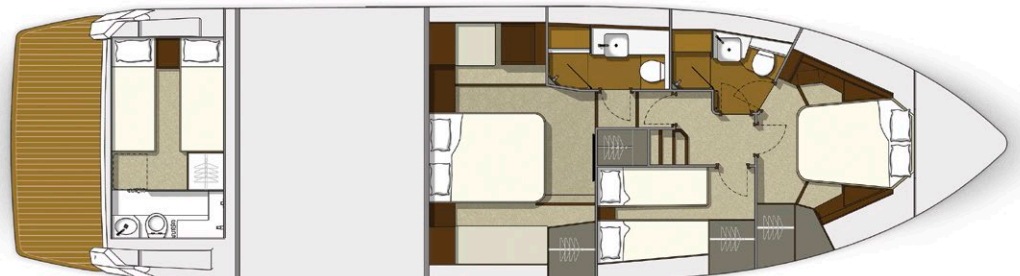
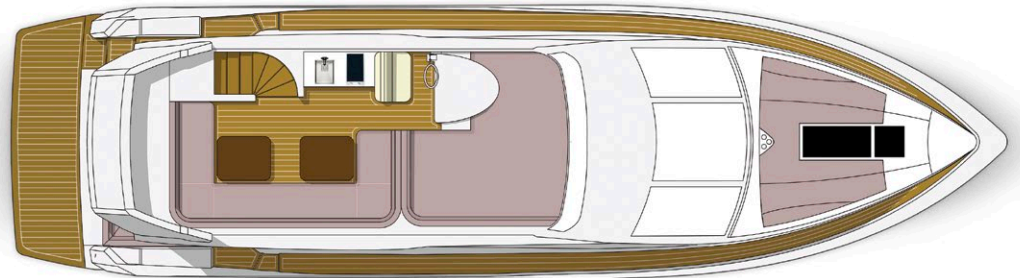

560 SKYDECK

Enjoy The
Endless Vistas





With a concealed bridge, the 560SKY is the best of both worlds



30 knot performance and a solid ride are hallmarks of the 560

The Galeon 560 Skydeck is a magnificent example of Old-World craftsmanship coming together with innovative design and today's technologies. Every detail is forged to impress even the most demanding aficionado.

Warm, rich woods, large, sweeping windows and supple materials combine to form impeccable accommodations to spend special times with family and friends or to entertain business associates in grand style. Scenic views abound through large sweeping windows throughout the saloon, forward helm and gourmet galley. The master stateroom offers sumptuous space to enjoy private time in ultimate comfort.

Enjoy morning coffee with a view on the en-suite settee. Bring the outdoors inside with the opening sunroof and windows. Powerful and graceful, the Galeon 560 Skydeck performs with solid poise that creates a spirit of confidence and assurance operating from either helm.



— Enormous salon and galley blend beautifully



— The retractable sunroof at the lower helm makes this yacht truly unique



— Full beam master with walk around queen and desk



— Beautifully appointed VIP with plenty of storage



Open or close the skydeck with the touch of a button



Large opening windows and skylight allow a cool breeze through the boat



Expansive cockpit for entertaining

560 SKYDECK

Layouts

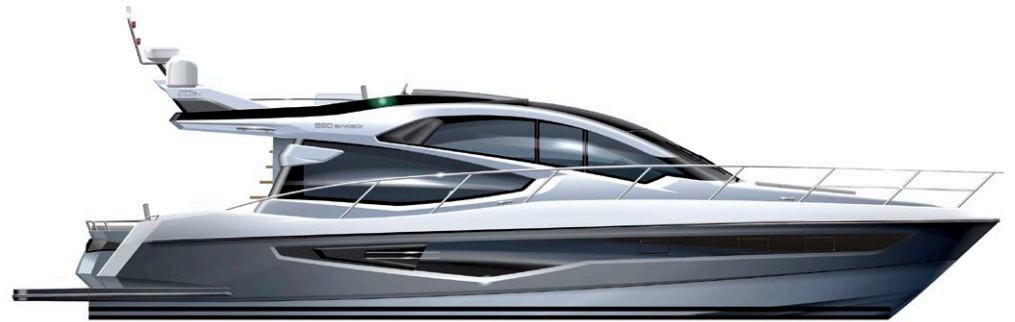

640 FLY

Break
the Mold





Game changing features in a thoroughbred performer



Expandable balconies and movable bow seating transcend the 640s actual dimensions

The 640 FLY transcends mere form and function with stunning contemporary design and expertly hand-crafted interiors.

The 640 FLY transcends mere form and function with stunning contemporary design and expertly hand-crafted interiors. This transformative yacht is revolutionizing the segment with its' innovative approach to layout. With powerful propulsion systems and advanced electronics, the Galeon 640FLY delivers experiences that create lifelong memories of times spent with friends and family. All with a style that will make its owner the envy of any port-of-call.

Outside, the aft cockpit dining area holds eight people who can enjoy an entertainment system with a flat screen TV sliding up from the galley, all while protected from the elements by the electric aft sunshade. The expandable balconies provide for cockpit space that rivals that of 100 foot yachts with over 23' feet of beam when open. The expandable bow area, accessed through the forward salon, and enormous bridge deck will have you believing you are on a much larger yacht.

Built using the latest advancements in resin infusion and structural carbon fiber and available in a 3 or 4 cabin layout, the 640FLY exceeds all expectations.



— The interior volume is beyond compare



— The enormous salon converts from dining to lounging with a button



— Dual helm seats command attention



— Take delight in the full beam master and settee



The most amazing feature, a pass through window to the bow



Expansive bridge with bar, lounge, and seating for plenty

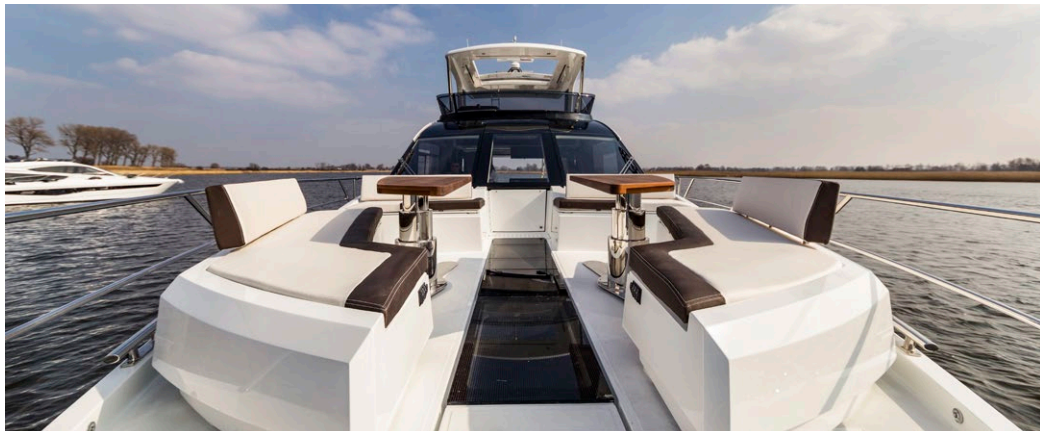

Expandable bow seats and tables extend the innovation

64.0 FLY

Layouts

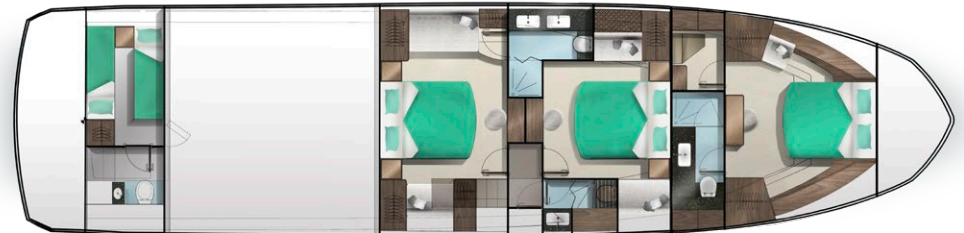
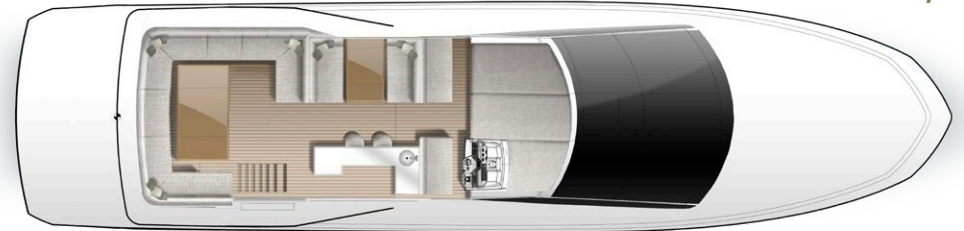

650 SKYDECK

Shattering
Expectations





Expanding on the innovation of the 640FLY, the 650SKY captures the imagination



30 knot performance and unrivaled appearance

The brand new 650 SKYDECK is the pinnacle of design and technical prowess and is the standard to which all yachts in the class will be measured.

Be transcended and transformed as the 650SKY leaves you breathless as her volume belies her physical dimensions and every turn offers a game changing innovation.

The carbon fiber SKYdeck roof panels eloquently disappear to reveal a large bridge while the available tender garage and rotating cockpit seat provide for endless vistas and truly unique experiences onboard.

With the proportions of larger yachts designed carefully into an amazing package, the 650SKY delivers on Galeon's hallmarks of Innovation, Hand-Crafted Quality, and Performance.



— Luxuriously appointed galley and salon



— Comfort and quality exude from every corner



— The forward cabin has a private entry with en suite head



— Beautiful full beam master and tiled head with rain shower



Open and close the large SKYdeck with the touch of a button —



The cockpit is a natural gathering place with outdoor kitchen —

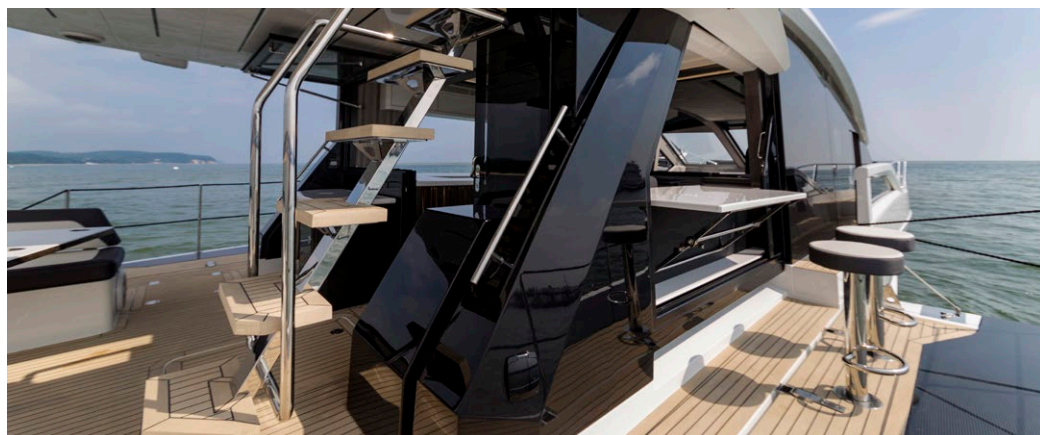

Start your day with breakfast on the bay —

650 SKYDECK

Layouts

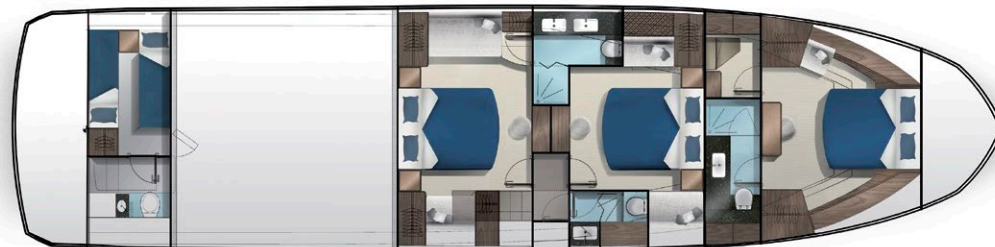

680 FLY

A Perfect
Evolution



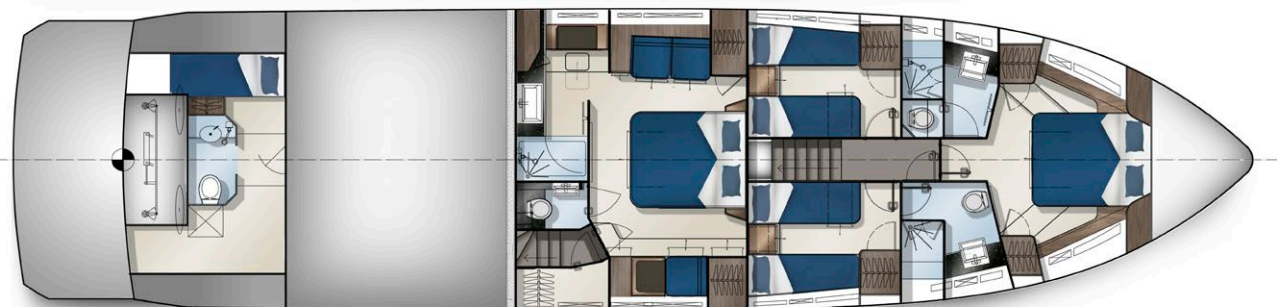
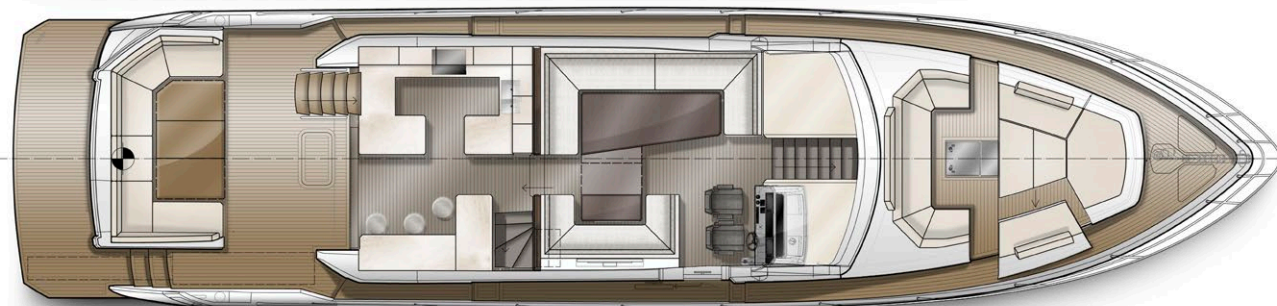
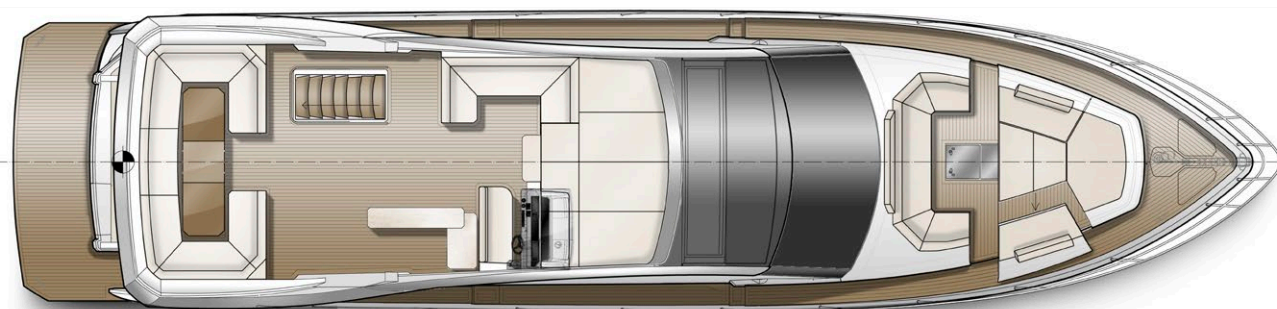

The 680 FLY changes the way yachts in all classes are measured. With a lightweight construction taking advantage of carbon technologies, its powerful power plant, stunning performance, and design, the 680 FLY features more game changing features.

On board the 680, passengers will find incredible volume, a bright and welcoming interior, and a luxurious finish.

The foredeck can be transformed into an expansive seating area with a touch of a button for sunning or sunset cruising. The vast FLYbridge is most impressive with plentiful seating, wet bar entertaining, and a carbon hard top and the opening windows in the salon allow cool breezes to sinuously blend inside and outside spaces. With 4 cabins, 30+ knot performance, and amazing innovation the 680FLY sets new benchmarks.

700 SKYDECK

SKY'S
The Limit





Simply amazing style and class



Beauty in design experienced from every angle

The striking exterior presence and its dynamic profile are staples of the SKYdeck design philosophy. For added functionality, a lightweight carbon hard top option is available.

A glass sunroof above the helm station and large glass panels to both port and starboard quickly retract, opening up the whole salon, a first in class and a continuation of Galeon's game changing open air designs. The SKY deck is fitted with twin sport seats, wet bar, and a generous seating area.

Board the 700 and experience the finest selection of materials meticulously finished by the best and most experienced Galeon craftsman. Four staterooms and three heads await, all with ample headroom and plenty of storage space while powerful engines fully realize the yacht's potential.



— A smaller, twin bed cabin

700^{SKYDECK}



Layouts

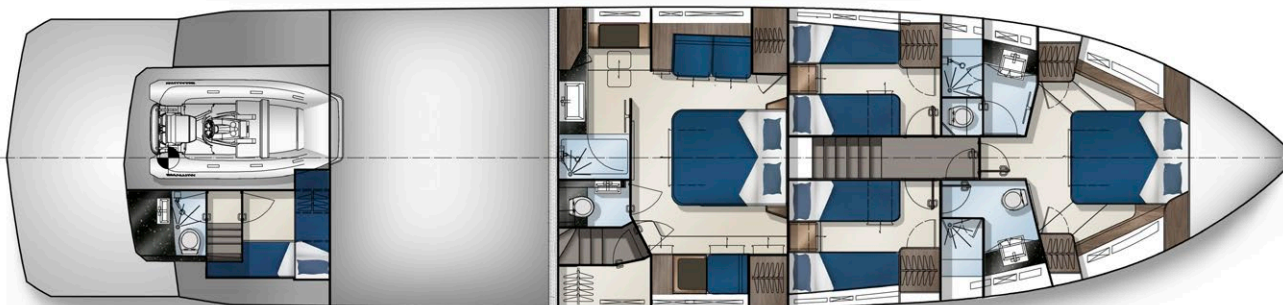
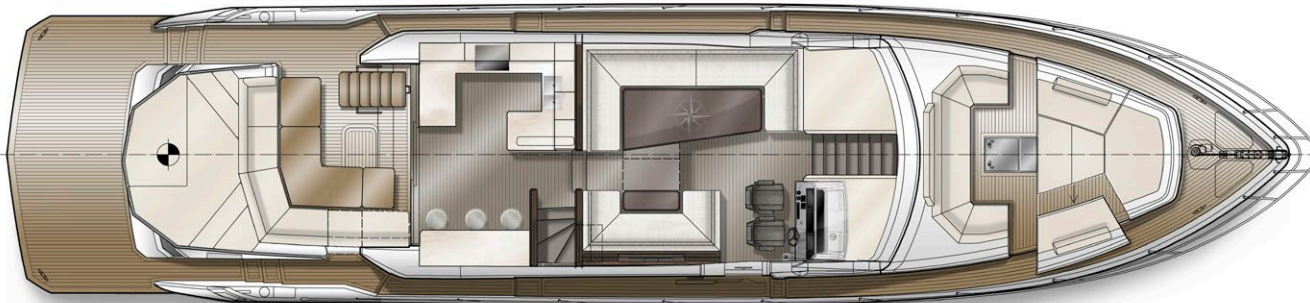
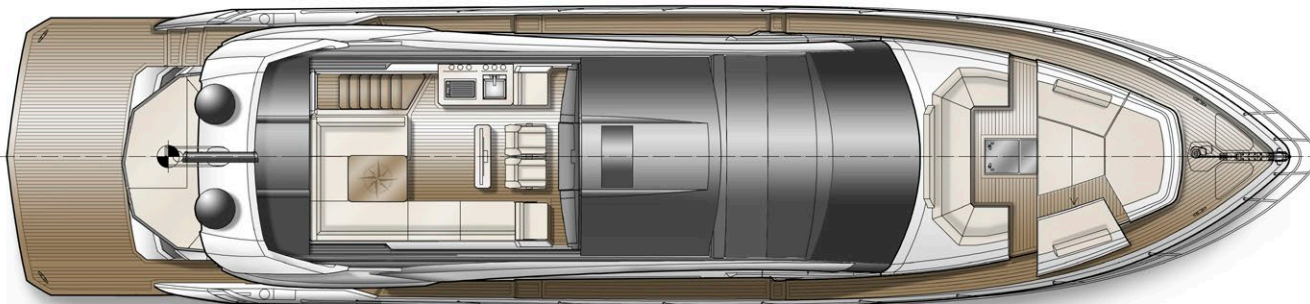

Coming
soon!

780^{FLY}

Fast, Furious,
and Elegant





The Flagship commands attention and embodies everything Galeon



Sleek profile and powerful performance

The Galeon 780 is a showcase of engineering, design and technological potential.

The stunning exterior offers an abundance of space on all three decks. The clever seating arrangement on the flybridge allows for design flexibility and makes for an enormous entertaining platform. The cockpit offers easy access to the bar on the main deck and to the bow leisure area, which is protected by an automatic bimini system.

The Crystal's exciting lines also make for a maximum amount of natural light available in all of the cabins.

The main deck is always bathed in sunlight thanks to the broad side windows and large sliding doors. The salon is divided into two main areas, one for leisure with comfortable sofas, bar and entertainment systems and one for dining with a very spacious galley and a dinette for six. The helm station provides excellent visibility and functionality while guests will enjoy the extra sofa and slide-down window.

Below, all four cabins have private in-suite bathrooms for extra comfort and privacy. Superb performance – due to flawless design and cutting-edge technology – sets the 780FLY apart. The height of engineering, performance and design excellence – the 780 Crystal is without peer.



— The enormity of the salon will amaze



— Dining for 6 opposite the fully appointed galley



— Commanding helm with lounge



— Full beam master with en suite head and walk in closet



Bow seating with a bimini and sun lounge makes for lovely hideaway



Massive bridge offers endless possibilities



Cockpit with available aft serving bar, TV, and privacy shade

780^{FLY}

Layouts

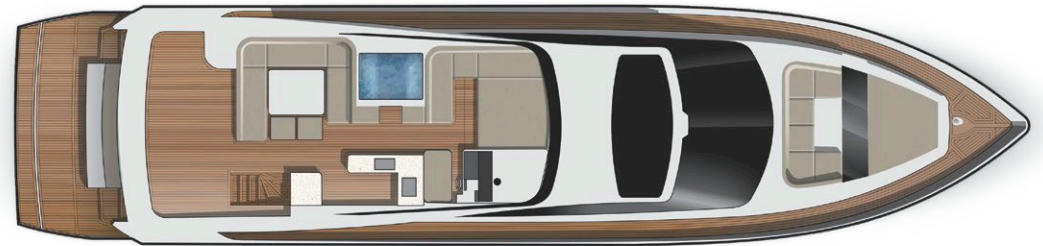

Technical

| | | 405 HTS | 420 FLY | 425 HTS | 430 HTC | 460 FLY | 470 SKYDECK | 485 HTS | 500 FLY | 510 SKYDECK | 550 FLY | 560 SKYDECK | 640 FLY | 650 SKYDECK | 680 FLY | 700 SKYDECK | 780 FLY |
|--|----------|----------------|----------------|---------------|----------------|----------------|----------------|---------------|----------------|----------------|----------------|----------------|-----------------|-----------------|-----------------|-----------------|------------------|
| Length of the hull | [ft] | 39'4" | 38'8" | 39'5" | 38'8" | 42'4" | 42'4" | 43'7" | 47'4" | 47'4" | 52' | 52' | 60'5" | 60'5" | 65' | 65' | 75' |
| Length overall | [ft] | 44'2"* | 43'6" | 44'1" | 43'6" | 47'5" | 47'5" | 49'2" | 53'2" | 53'2" | 58'1" | 58'1" | 68'3" | 68'3" | 72' | 72' | 80'5" |
| Beam of the hull | [ft] | 12'7" | 13'5" | 13'5" | 13'5" | 14'2" | 14'2" | 13'9" | 14'5" | 14'5" | 15'5" | 15'5" | 16'5" / 20'3" | 16'5" / 20'3" | 17'2" | 17'2" | 19' |
| Beam overall | [ft] | 12'10" | 13'8" | 13'8" | 13'8" | 14'4" | 14'4" / 16'6" | 13'11" | 14'8" / 19'8" | 14'8" / 19'8" | 15'7" | 15'7" | 17'3' | 17'3" | 17'3" | 17'3" | 19'3" |
| Draft max | [ft] | 3'5" | 3'11" | 3'11"* | 3'11" | 4'3" | 4'3" | 3'11" | 4'7" | 4'7" | 4'7" | 4'7" | 4'10" | 4'10" | 4'11" | 4'11" | 5'11" |
| Bridge clearance | [ft] | 13'9" | 14'5" | 14'2"* | 13'9" | 15'10" | 15'10" | 16'9" | 16'9" | 16'9" | 17'1" | 17'1" | 24'9" | 23'11" | TBD | TBD | 24'11" |
| Fuel tank capacity | [US Gal] | 251 | 290 | 251 | 290 | 396 | 396 | 336 | 476 | 476 | 580 | 580 | 686 | 686 | 924 | 924 | 1450 |
| Water tank capacity | [US Gal] | 119 | 119 | 119 | 119 | 172 | 176 | 119 | 172 | 172 | 185 | 185 | 211 | 211 | 265 | 265 | 475 |
| Black water tank | [US Gal] | 37 | 40 | 40 | 40 | 53 | 53 | 32 | 63 | 63 | 53 | 53 | 55 | 55 | 80 | 80 | 135 |
| Mass of Light Craft Condition ₁ | [lbs] | 21250 | 26610 | 22500* | 26610 | 36375 | 36375 | 29990 | 50200 | 50200 | 53500 | 53500 | 68500 | 67,000 | 74500 | 73500 | 120250 |
| Maximum Load | [lbs] | 5200 | 6000 | 5500* | 6000 | 8500 | 8500 | 6900 | 9400 | 9400 | 9900 | 9900 | 12125 | 13670 | 14550 | 14550 | 20400 |
| Propulsion | [kW/HP] | 2 x 272/370 | 2 x 320/435 | 2 x IPS500 | 2 x 320/435 | 2 X 405/550 | 2 x 405/550 | 2 X IPS600 | 2 X 493/670 | 2 X 493/670 | 2 X 533/725 | 2 X 533/725 | 2 X 882/1200 | 2 X 882/1200 | 2 X 882/1200 | 2 X 882/1200 | 2 X 1412/1920 |

₁ - minimum mass with base engines * - with extended stern platform ** - estimated

The right is reserved to make changes, without notice, at any time, in equipment, materials, and specifications.

Drawings, photos, and renderings may show optional or unavailable equipment.

USA



MarineMax Headquarters

Call: 1-888-983-4925

www.galeonyachts.us

www.marinemax.com

www.marinemaxyachts.com

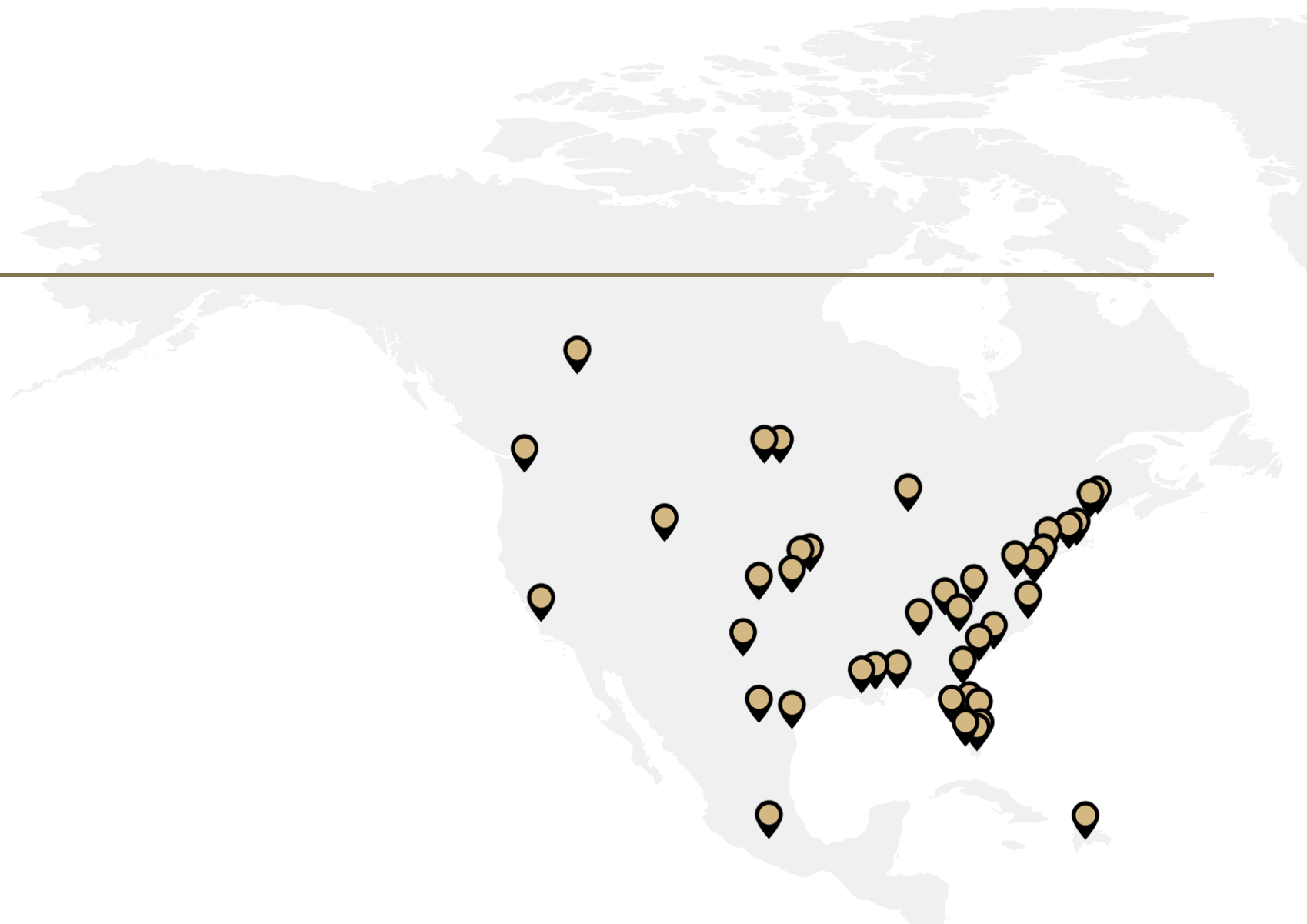



The Galeon Range
Experience Innovation





GALEONYACHTS.US